

FLEX LANCES

Continued from previous page

9/16-18 THREADED LANCES	SWIVEL SIZE	TOOL END CONNECTION	LENGTH		INSIDE DIA.		OUTER DIA.		CRIMP DIA.		MAWP		WEIGHT		MIN. BEND RAD.	
			ft	m	in	mm	in	mm	in	mm	psi	bar	lb/ft	kg/m	in	mm
ACHO H84035FTM9NZLM	3/4 Type M	9/16-18 LH Male BP	35	10.7	0.32	8.1	0.57	14.6	0.79	20.3	21750	1500	0.261	0.390	7.09	108
ACHO H84035FTM9NZRM	3/4 Type M	9/16-18 RH Male BP	35	10.7	0.32	8.1	0.57	14.6	0.79	20.3	21750	1500	0.261	0.391	7.09	108
ACHO H84035FTM9ZLM	3/4 Type M	9/16-18 LH Male BP	35	10.7	0.32	8.1	0.57	14.6	0.79	20.3	21750	1500	0.261	0.392	7.09	108
ACHO H84035FTM9ZRF	3/4 Type M	9/16-18 RH Female	35	10.7	0.32	8.1	0.57	14.6	0.79	20.3	21750	1500	0.261	0.393	7.09	108
ACHO H84050FTM9NZLM	3/4 Type M	9/16-18 LH Male BP	50	15.25	0.32	8.1	0.57	14.6	0.79	20.3	21750	1500	0.261	0.394	7.09	108
ACHO H84050FTM9NZRM	3/4 Type M	9/16-18 RH Male BP	50	15.25	0.32	8.1	0.57	14.6	0.79	20.3	21750	1500	0.261	0.395	7.09	108
ACHO H84050FTM9ZRF	3/4 Type M	9/16-18 RH Female	50	15.25	0.32	8.1	0.57	14.6	0.79	20.3	21750	1500	0.261	0.396	7.09	108

TYPE M MALE CONNECTORS

PART NO.	CONNECTION TYPE		MAX. OPERATING PRESSURE	
	Connection 1	Connection 2	psi	bar
AF 060-060	9/16 Type M Male	9/16 Type M Male	44,000	1500
AF 060-061	9/16 Type M Male	3/4 Type M Male	22,000	1500
AF 060-063	9/16 Type M Male	1" Type M Male	22,000	1500
AF 061-061	3/4 Type M Male	3/4 Type M Male	22,000	1500
AF 061-063	3/4 Type M Male	1" Type M Male	22,000	1500
AF 061-064	3/4 Type M Male	1-5/16 Type M Male	22,000	1500
AF 062-062	7/8 Type M Male	7/8 Type M Male	44,000	3000
AF 062-063	7/8 Type M Male	1" Type M Male	22,000	1500
AF 063-063	1" Type M Male	1" Type M Male	22,000	1500
AF 063-064	1" Type M Male	1-5/16 Type M Male	22,000	1500
AF 064-064	1-5/16 Type M Male	1-5/16 Type M Male	22,000	1500

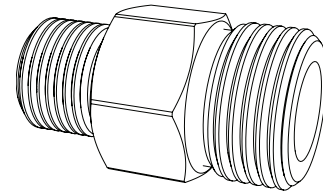

TYPE M MALE TO MEDIUM PRESSURE MALE CONNECTORS

PART NO.	CONNECTION TYPE		MAX. OPERATING PRESSURE	
	Connection 1	Connection 2	psi	bar
AF 060-MP4	9/16 Type M Male	1/4 MP Male	22,000	1500
AF 060-MP6	9/16 Type M Male	3/8 MP Male	22,000	1500
AF 060-MP9	9/16 Type M Male	9/16 MP Male	22,000	1500
AF 060-MP12	9/16 Type M Male	3/4 MP Male	22,000	1500
AF 060-MP16	9/16 Type M Male	1" MP Male	22,000	1500
AF 061-MP6	3/4 Type M Male	3/8 MP Male	22,000	1500
AF 061-MP9	3/4 Type M Male	9/16 MP Male	22,000	1500
AF 061-MP12	3/4 Type M Male	3/4 MP Male	22,000	1500
AF 061-MP16	3/4 Type M Male	1" MP Male	22,000	1500
AF 063-MP9	1" Type M Male	9/16 MP Male	22,000	1500
AF 063-MP12	1" Type M Male	3/4 MP Male	22,000	3000
AF 063-MP16	1" Type M Male	1" MP Male	22,000	1500
AF 064-MP9	1-5/16 Type M Male	9/16 MP Male	22,000	1500
AF 064-MP12	1-5/16 Type M Male	3/4 MP Male	22,000	1500
AF 064-MP16	1-5/16 Type M Male	1" MP Male	22,000	1500

